



COMFORT KAISER / COMFORT KAISER DUO

Reference 7608N / 7609N
USER MANUAL

SEP. 2009/1h

LOCATION OF CONTROLS

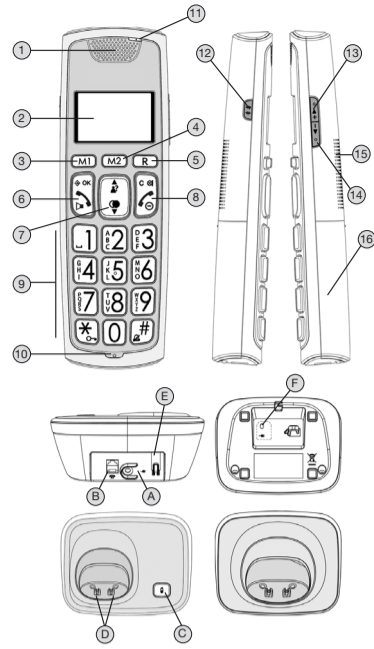

2

- 1. Ear speaker.**
- 2. Screen.**
- 3. [M1] Key:** Direct memory 1. In standby mode, long press to dial the stored number.
- 4. [M2] Key:** Direct memory 2. In standby mode, long press to dial the stored number.
- 5. [R] Key:** Press R in standby mode to access the callback function. Press to access the address book.
- 6. [OK] Key:**
 - Upper part of the key: \diamond OK
 - Press the key in standby mode to enter the main menu.
 - Press it in a submenu to confirm your selection.
 - Press it during a call to access the options: Internal call, Address book, Last dialed numbers list and Call list.
 - Lower part of the key: \blacktriangleright
 - In standby mode, press briefly to pick up.
 - Press it in the address book or in one of the lists to access the selected entry, and press it again to activate the hands-free function.
 - Press it during the call to answer the call, and press it again to activate the speakerphone function.
- 7. [CALL] Key:**
 - Upper part of the key: \uparrow
 - Press it in standby mode to access the call list.
 - Press it within a menu to move to the next option.
 - Press it in the address book or in one of the lists to scroll to the next entry.

3

- Lower part of the key: \downarrow
 - Press it in standby mode to access the list of last dialed numbers.
 - Press it within a menu to go to the previous option.
 - Press it in the address book or in one of the lists to scroll to the previous entry.
- 8. [END] Key:**
- Upper part of the key: \odot
 - Press it in menu mode to return to standby mode.
 - Press it in any submenu to return to the previous level, or press and hold it to go directly to standby mode.
 - In edit or preset mode, press to delete a letter or digit, or press and hold to delete all letters or digits at once.
- Lower part of the key: \leftarrow
- In standby mode, press and hold the key to turn off the phone.
 - When the phone is off in standby mode, press and hold the button to turn on the phone.
 - Press briefly in menu mode or edit mode to return to the previous menu, or press and hold to return to standby mode.
 - During a call, press to answer the call and press again to activate the speakerphone function.
 - Press it during a call to end the call and return to standby mode.

4

9. Keypad.

- Press a key to insert a digit, character, * and #.
- In standby mode, press \leftarrow to access a stored number.
- In standby mode, press and hold the \times key to activate or deactivate the key lock.
- During a call in pulse dialing mode, press the \times key to temporarily switch to tone dialing mode.
- In standby mode, press and hold the \blacklozenge key to enable/disable the ringtone.
- In any of the lists, if applicable, press \blacklozenge to check the number associated with the record name or to view the time of the call in the DETAILS submenu.
- In dialing mode, when preparing to dial or editing a number, press and hold \square to insert a pause, P.

10. Microphone.

11. Indicator light:

- Stays on when the amplification mode is activated.
- Flashes when there is an incoming call.

12. Amplification key: \odot

- Press it during a call to activate or deactivate the amplification of the ear speaker.

13. Key to increase the volume: \uparrow

- Press it during a call to increase the volume of the ear speaker.

5

14. Key to decrease the volume: \downarrow

- Press it during a call to decrease the volume of the ear speaker.

15. Speaker.

16. Battery cover.

- Connection power adapter.
- Connection of the line cable.
- Key used to search for the phone: \square
- In standby mode, press this key to locate your phone.
- Press and hold the key for a few seconds in registration mode to register a phone.
- Contacts for charging the battery.
- Cable entry.
- Power adapter cable input (7609N).

INSTALLATION

SCOPE OF DELIVERY

- Cordless phone.
 - Base
 - Line cable
 - Power supply unit for the base unit
 - 2 rechargeable batteries type LR3/AAA 500mAh (Ni-Mh)
 - Instruction manual and SAT list
- And additionally, if you have purchased the DUO version:
- 1 additional cordless telephone.
 - 1 additional phone charger with power supply.
 - 2 additional rechargeable batteries type LR3/AAA 500mAh (Ni-Mh).

6

BASE UNIT LOCATION

It is important that the base and cordless phone can receive and transmit a good radio signal. The best location is in the center of the area you want to cover. If you have poor reception, try relocating the base.

The indoor range is up to 50 meters. Do not place the device near TVs, computers or electrical devices as this may affect the range and sound quality.

INSTALLING THE PHONE

Place the charging station near the telephone line and the power outlet (power connection).

- Plug one end of the power adapter into the power connector of the base unit (A). Connect the power adapter to a 220 V socket. For the DUO version, proceed in the same way to power the charger.
- Plug one end of the power cord into the back of the base station (B) and the other end into your home phone jack.
- Insert the batteries into the battery compartment on the back of the phone. To do this, open the battery compartment (16) with light pressure and slide the cover down. Insert the batteries, taking care to observe the correct polarity. Observe the drawings (+ and -) on the inside of the compartment. Replace the cover. For the DUO version, proceed in the same way with the additional telephone.

7

4. Then place the phone in the charging cradle to charge the batteries. Charge the batteries for at least 10 hours during the first installation. In the case of the DUO version, place the additional phone in the charging cradle.

5. If the battery icon on the phone moves, it means that the batteries are not fully charged. However, when fully charged, the icon remains stable and shows |||| .

6. The phone is pre-programmed to automatically connect to the charging cradle. If it does not, unplug the power cord from the cradle, remove the batteries from the phone, plug the power cord back into the cradle, and reinsert the batteries. If the connection still cannot be established, program the device by following the instructions in the "Registering a phone" section.

8

SET THE CLOCK OF THE PHONE

You can set the following clock settings on your phone: the DATE FORMAT, the TIME FORMAT, the TIME and the DATE. To do this:

- Press the \diamond OK key to enter the menu.
- Press the \leftarrow key until CLOCK is selected. Press \diamond OK.

NOTE: Remember that you can press the \odot key at any time to return to the previous screen or press and hold the \leftarrow key for a few seconds to return to sleep mode.

■ Set date format

Once you have entered the CLOCK submenu, you can set one of the following clock formats: DD-MM-YY or MM-DD-YY. To do this, proceed as follows:

- Press the \leftarrow key until FT DATE is selected. Press \diamond OK.
- Press the \leftarrow key until the desired format is selected: DD-MM-YY or MM-DD-YY.
- Press \diamond OK, to confirm the date format. You will hear a confirmation tone.

The day format is DD-MM-YY by default.

■ Set time format

Once you have entered the CLOCK submenu, you can set one of the following time formats: 12HR or 24HR. To do this, proceed as follows:

- Press the \leftarrow key until FT TIME is selected. Press \diamond OK.
- Press the \leftarrow key until the desired format is selected 12HR or 24HR.
- Press \diamond OK. You will hear a confirmation tone.

The time format is 24HR by default.

9

■ Set time

Once you have entered the CLOCK submenu, you can set the time. To do this, proceed as follows:

- Press the \leftarrow key until TIME is selected.
- Press \diamond OK. The first digit of the hours starts flashing.
- Use the keypad to enter the two digits corresponding to the hours. Then the minute display starts to flash.
- Use the keypad to enter the two digits corresponding to the minutes.
- Press \diamond OK. You will hear a confirmation tone.

By default, the time is 00 - 00.

■ Set date

Once you have entered the CLOCK submenu, you can set the date. To do this, proceed as follows:

- Press the \leftarrow button to select DATE.
- Press \diamond OK. The first digit of the day field starts flashing.
- Use the keypad to enter the two digits corresponding to the day. After that, the digit in the month field starts to flash.
- Use the keypad to enter the two digits of the month. The digit in the year field then starts to flash.
- Use the keypad to enter the two digits that correspond to the year. Press \diamond OK. You will hear a confirmation tone.

By default, the date is 01 - 01 - 11.

10

SET ALARM

To set the alarm on the phone, proceed as follows:

- Press \diamond OK to enter the menu.
- Press the \leftarrow key until ALARM is selected. Press \diamond OK to confirm the selection.
- Press the \leftarrow key until ON is selected to set the alarm (OFF would be to remove the alarm). Press \diamond OK, to confirm the selection.
- Set the time at which the alarm is to sound. Use the keypad to enter the two digits that correspond to the hours. Then the minute display starts to flash.
- Use the keypad to enter the two digits corresponding to the minutes. Press \diamond OK to confirm the alarm time.
- The REPEAT option is displayed on the screen. Press \diamond OK to confirm the alarm time.
- Press the \leftarrow key until ON is selected for the alarm to sound regularly every 7 minutes, or OFF. Press \diamond OK. You will hear a confirmation tone.

By default, the alarm is disabled and the default melody is 1.

11

NOTE:

- The alarm duration is approx. 45 seconds.
- The volume of the alarm is equal to the ringtone volume of the phone itself. And when the phone is muted, the alarm sounds at volume 1.
- To stop the alarm, simply press any key or press and hold the \leftarrow key for about 5 seconds to turn it off permanently. In the latter case, the |||| icon will disappear.
- During a call, the alarm does not sound, but to warn you, the phone displays the message ON and the |||| icon flashes on the screen. In addition, an audible signal sounds in the phone. If it coincides with the ringing of a call, the alarm will not be triggered.

PHONE CONFIGURATION

You can configure the following parameters of your phone: the RINGTONE, the SOUNDS, the EQUALIZER, the LANGUAGE, the NAME, the SCREEN, the AUTO ANSWER function, the MEMORY and the ANSWERING MACHINE. Proceed as follows:

- Press the \diamond OK key to enter the menu.
- Press the \leftarrow key until TELEPHONE is selected. Press \diamond OK.

12

■ Setting the internal ringing melody

To do this, after entering the TELEPHONE submenu:

- Press the \leftarrow key until RINGTONE is selected. Press \diamond OK.
- Press the \leftarrow key until INTERNAL is selected. Press \diamond OK.
- The currently selected ringing melody is played.
- The screen displays 'MEL: x' (x = one of the 10 melodies). In addition, the currently selected melody is marked with a *.
- Press the \leftarrow key to hear the other melodies. There are 10 in total. Press \diamond OK. You will hear a confirmation tone.

By default, the internal call melody is 2.

■ Setting the external call melody

To do this, after calling the TELEPHONE submenu:

- Press the \leftarrow key until RING TONE is selected. Press \diamond OK.
- Press the \leftarrow key until EXTERNAL is selected. Press \diamond OK.
- The currently selected ringing melody is played.
- The screen displays 'MEL: x' (x = one of the 10 melodies). In addition, the currently selected melody is marked with a *.
- Press the \leftarrow button to hear the other melodies. There are 10 in total. Press \diamond OK. You will hear a confirmation tone.

The default setting for the external ring melody is 1.

13

■ Set ringtone volume

To do this, after entering the TELEPHONE submenu:

- Press the \leftarrow key until RINGTONE is selected. Press \diamond OK.
- Press the \leftarrow key until VOLUME is selected. Press \diamond OK.
- The melody is played at the currently selected ring volume.
- The display shows 'VOL x' (x = one of the 5 volume levels or mute). In addition, the current volume is marked with a *.
- Press the \leftarrow button to increase or decrease the volume. Press \diamond OK. You will hear a confirmation tone.

By default, the ring volume is set to 4.

■ Setting the key confirmation tone

This tone sounds every time a key is pressed.

To do this, after calling the TELEPHONE submenu:

- Press the \leftarrow key until TONE is selected. Press \diamond OK.
- Press the \leftarrow key until KEY is selected. Press \diamond OK.
- Press the \leftarrow key to select ON or OFF. Press \diamond OK. You will hear a confirmation tone.

The key confirmation tone is activated by default.

14

■ Low battery setting

This sound is emitted when the battery charge level is low. To do this, after entering the TELEPHONE submenu:

- Press the \leftarrow key until TONE is selected. Press \diamond OK.
- Press the \leftarrow key until LOW BAT is selected. Press \diamond OK.
- Press the \leftarrow button to select ON (Enabled) or OFF (Disabled). Press \diamond OK. You will hear a confirmation tone.

By default, the low battery sound is enabled.

■ Setting for out of range sound

This tone sounds when the phone has no signal, is not in range or has no reception. Once you have entered the TELEPHONE submenu, you can set it:

- Press the \leftarrow key until TONE is selected. Press \diamond OK.
- Press the \leftarrow key until NO SIGNAL is selected. Press \diamond OK.
- Press the \leftarrow key to select ON (Enabled) or OFF (Disabled). Press \diamond OK. You will hear a confirmation tone.

By default, the sound is activated when the range is exceeded.

15

■ Set audio equalizer

The phone has three types of filters to compensate for the limited sensitivity of the ear in certain frequency ranges. The filters are called: natural, bass and treble.

To set it, after entering the TELEPHONE submenu, you must perform the following steps:

- Press the \leftarrow key until EQUALIZE is selected. Press \diamond OK.
- Press the \leftarrow key until the desired filter is selected: NATURAL, BASS or TREBLE. Press \diamond OK. You will hear a confirmation tone.

The audio equalizer filter is set to NATURAL by default.

■ Language settings

You can choose from one of the different languages: English, Deutsch, Français, Italiano, Türkçe, Español, Ελληνικά, Svenska, Dansk, Norsk, Nederlands, Suomi.

To do this, after entering the TELEPHONE submenu:

- Press the \leftarrow key to select LANGUAGE. Press \diamond OK.
- Press the \leftarrow key until you have selected the language of your choice. Press \diamond OK. You will hear a confirmation tone.

By default, the language is SPANISH.

16

■ Configure phone name

Each phone can have its own name for identification. It is displayed on the screen in idle mode and permanently. You can change the name to a maximum of 6 alphanumeric characters.

To do this, after entering the TELEPHONE submenu:

- Press the **[F]** key until NAME is selected. Press **⇨OK**.
- Delete the default name using the **C ⊗** key and enter the desired name for the phone using the keypad (max. 6 characters). Press **⇨OK**. You will hear a confirmation tone.

By default, the name is SPC.

NOTE: In standby or idle mode, the phone displays SPC x (where "x", from 1 to 5, is the number of the device).

■ Setting the display information in standby mode

The phone gives you the option to choose what information you want to be displayed when the phone is in standby or idle mode: the name or the time.

To do this, after entering the TELEPHONE submenu:

- Press the **[F]** key to select SCREEN. Press **⇨OK**.
- Press the **[F]** key until you select the type of information to be displayed: NAME or TIME. Press **⇨OK**. You will hear a confirmation tone.

By default, the following types of information are displayed: NAME.

17

■ Setting the automatic pickup

When automatic pickup is enabled, you can answer a call by simply lifting the phone from the base station.

To configure it, you must enter the TELEPHONE submenu:

- Press the **[F]** key to select AUTO ANSWER. Press **⇨OK**.
- Press the **[F]** key to select ON (Enabled) or OFF (Disabled). Press the **⇨OK**. You will hear a confirmation tone.

In the default setting, automatic pickup is disabled.

■ Set direct memory

Your phone has 2 direct memories: M1 and M2. You can program a number with up to 20 digits in each of the memories.

To do this, after entering the TELEPHONE submenu:

- Press the **[F]** key to select MEMORY. Press **⇨OK**.
- Use the **[F]** key to select the memory to be programmed: M1 or M2. Press **⇨OK**.
- Enter the desired number using the keypad (maximum 20 digits). If you make a mistake, you can also delete it by pressing the **C ⊗** key. Press **⇨OK**. You will hear a confirmation tone.

18

■ Configuration of the voicemail memory

Your phone also has an additional memory on the **[1]** key. This key is usually programmed with your phone company's voicemail access number, but you can also record an SOS number such as 112.

To do this, after entering the TELEPHONE submenu:

- Press the **[F]** to select VOICEMAIL. Press **⇨OK**.
- Enter the desired number using the keypad (maximum 20 digits). If you make a mistake, you can also delete it using the **C ⊗** key. Press **⇨OK**. You will hear a confirmation tone.

CONFIGURATION OF THE BASE

You can configure the following basic parameters: DIALING, the R-TIME and the PIN. To do this:

- Press the **⇨OK** key to enter the menu.
- Press the **[F]** key until BASE is selected. Press **⇨OK**. You will hear a confirmation tone.

19

■ Set dialing mode

To ensure compatibility with different systems, your phone can be programmed with either PULSE or TONE DIALING.

To do this, after you have entered the BASE submenu:

- Press the **[F]** key until DIALING is selected. Press **⇨OK**.
- With the **[F]** key, select one of the two options: TONE or PULSE. The current dialing mode is marked with an *. To confirm, press **⇨OK**. You will hear a confirmation tone.

By default, the dialing mode is set to TONE.

■ Setting the redial (R key)

The R key **(5)** is useful if you want to use the services offered by your telephone company or switchboard, such as "call forwarding", "call waiting", "answering machine", etc.

To do this, after you have entered the BASE submenu:

- Press the **[F]** key until R time is selected. Press **⇨OK**.
- With the **[F]** key, select one of the options: SHORT (100 ms), MEDIUM (300 ms) or LONG (600 ms). The current dialing mode is marked with *. To confirm, press **⇨OK**. You will hear a confirmation tone.

By default, the R key **(5)** has a SHORT time of 100 ms.

NOTE: The R key (5) for Spain is 100ms. If you change this setting, you may no longer be able to use some of the services offered by your telephone company.

20

■ Setting the base pin

To restrict access to programming of some important parameters, your phone is protected with a user PIN. You can change this PIN. The maximum number of digits is 4.

To do this, after you have entered the BASE submenu:

- Press the **[F]** key until PIN is selected. Press **⇨OK**.
- The screen will display 'OLD?'. Press **⇨OK**.
- Use the keypad to enter the new PIN again, then press **⇨OK**. You will hear a confirmation tone.
- The screen displays 'NEW?'. Press **⇨OK**.
- Use the keypad to enter the new 4-digit base pin and press **⇨OK** to confirm.
- The phone will ask you to confirm the new PIN and 'CONFIRM?' will appear on the screen. Press **⇨OK**.
- Use the keypad to enter the new PIN again, then press **⇨OK**. You will hear a confirmation tone.

By default, the base pin is 0000.

NOTE: If you change your PIN, choose one that you can easily remember or write it down in a safe place.

21

DEFAULT VALUES (RESET)

This function allows you to reset all options to their programmed default values. It is as if we were turning on the phone for the first time. To do this:

- Press the **⇨OK** key to enter the menu.
- Press the **[F]** key until RESET is selected. Press **⇨OK**.
- The phone prompts you to enter the PIN. PIN? appears on the screen.
- Use the keypad to enter the new 4-digit base pin and press **⇨OK** to confirm.
- The phone will ask you to confirm the action. The screen will display CONFIRM?
- Press **⇨OK**, to confirm. The phone will display the message WAIT and when the process is complete, you will hear a confirmation tone.

NOTE: Remember that you can press the **C ⊗** key at any time to return to the previous screen or press and hold the **[F]** key for a few seconds to return to sleep mode. It is not recommended to use this function as all configurable functions of the base will be reset to factory settings.

22

BASIC FUNCTIONS

TURN THE PHONE ON AND OFF

To turn off the phone, press and hold the **[F]** key for about 5 seconds. In this state, where no power is consumed, the batteries retain their charge.

To turn on the phone, press and hold the **[F]** key until the screen lights up and the message 'SEARCH' is displayed. Also, when the phone is turned off, it will automatically turn on when placed in the charging cradle for charging.

NOTE: The phone is pre-programmed to automatically connect to the base. If it does not, the **[F]** icon will flash on the screen. Then unplug the power cord from the cradle, remove the batteries from the phone, plug the power cord back into the cradle, and reinsert the batteries. If the connection still cannot be established, connect the device by following the instructions in the Registering a phone section.

STANDBY MODE

The standby mode is the home screen that appears every time you turn on the phone. When the phone is in standby mode, it is ready to receive calls and you will see at least the **[F]** icon, the battery status **[B]**, the name of the phone or the time and number of the phone (from 1 to 5). After a few seconds, the phone will enter a power saving mode where the screen backlight will turn off. The screen turns on again when you receive a call or press any key on the phone.

NOTE: The power saving mode extends the runtime and battery life.

23

MAKING AND RECEIVING CALLS

There are several ways to make calls from your phone:

■ Traditional way

- Press the **[F]** key to pick up the line. You will hear the dial tone and the **[F]** icon will appear at the top of the screen.
- Dial the phone number and it will be displayed on the screen. When the other person answers, start the call.
- To end the call, press the **[F]** key or place the phone on the base (or charging cradle for the DUO version).

■ Dial Preparation Mode

This mode is very useful when you want to double check and possibly correct the number before dialing:

- Enter a phone number in standby mode. Check the number on the screen.
- If you have made a mistake, correct it with the **C ⊗** key.
- If the number is already correct, press the **[F]** key to dial it. The screen will show you the number while the phone dials it automatically.
- When they pick up, you speak at normal volume. During the call, the call time (hh:mm:ss) is displayed on the screen.
- To end the call, press the **[F]** key or place the phone on the base (or charging cradle for the DUO version).

NOTE: While dialing the number, you can enter pauses of about 3 seconds by holding down the **[F]** key. The display will show the letter P, which is considered an additional digit for all purposes.

24

■ Turbo mode

In this mode, you can quickly dial the most frequently dialed numbers previously stored in the memories: M1, M2 and the keys 1~9.

- Press and hold the M1, M2 keys or the 1-9 keys on the keypad for a few seconds.
- The phone automatically connects, displays the corresponding number on the screen and dials it.

NOTE: If the key you press is empty, the phone emits error tones. See the Configuring Direct Memory section for assigning a number to the M1 and M2 keys (Direct Memory), Configuring Voicemail Memory for assigning it using the 1 key on the keypad (Voicemail Memory), and Assigning a Number to a Turbo Memory for assigning it using the 2-9 keys on the keypad.

■ Receiving a call

When a call comes in, the phone rings, the **[F]** icon and the text 'CALL' are displayed and the indicator light **(11)** on the phone starts flashing.

- When the phone rings, you can answer the call by pressing the **[F]**.
- During the call, the screen displays the call time.
- To end the call, press the **[F]** key or place the phone on the base station (or charger for ref. 7609N).

25

■ Call waiting

This phone provides the ability to use the caller ID service while on hold. Your line has a caller ID service and a call waiting service. If you receive a call while your line is busy, the number of the caller is displayed in addition to the call waiting tone in the handset.

- If you receive another call during a telephone conversation, you will hear a series of short tones in the handset. The phone displays the number of the party calling you.
- Press the **[F]** key and then the digit 2 to put the first call on hold and answer the second call.
- Press the **[F]** key again and then the number 2 to switch from one call to another.

NOTE: This function is network dependent. Please contact your telephone company for more details about the service.

■ Voicemail

When someone leaves a message in your voice mailbox, the **[F]** icon appears on the screen. After you delete all messages from your voice mailbox, you will receive a signal from your phone company without an associated number and the **[F]** icon will disappear. For more information, see the section **Deleting the voicemail icon**.

NOTE: This function is network dependent. Please contact your telephone company for more details about the service.

■ Call time

The phone has a timer that appears on the screen after a few seconds and shows the approximate duration of your call: hh:mm:ss.

26

■ Set audio volume

During the call, you can use the **[13]** and **[14]** keys to adjust the volume of the sound or the speakerphone. You can also do this with the **[13]** and **[14]** keys. There are 5 levels. The higher the number, the higher the volume: **Vol 5**, higher volume; **Vol 1**, lower volume (default: **Vol 3**).

■ Audio amplification

The phone has an additional amplification (+10dB) of the handset volume to compensate for the limited hearing sensitivity of some people. To activate the function during a call, press the **[F]** key. The message "AMPL ON" appears on the screen and the telephone indicator lamp **(11)** lights up. Then the five audio levels are increased by +10 dB.

To deactivate the function, press the **[F]** key again. "AMPL OFF" appears on the screen and the telephone indicator light **(11)** goes out. The five audio levels then return to their normal values.

NOTE: The audio amplification function is automatically switched off at the end of the call. i.e. it is only active during the current call.

■ Mute the microphone (Mute)

During a call, you can temporarily mute the microphone so that the person you are talking to cannot hear you. However, during this time you can still hear them.

To enable or disable the mute microphone function:

- Press the **C ⊗** key during the call. The message "MUTE" is displayed on the screen.
- Press the same **C ⊗** key again to deactivate the function. The message "MUTE" disappears.

27

■ Hands-free calling

During a call, you can activate the phone's speaker. If you then place the phone on a surface (e.g. the desk), you can have a hands-free call.

To activate or deactivate the speakerphone, press the **[F]** key while the handset is off-hook.

The **[F]** icon is displayed on the screen.

To deactivate the speakerphone and return to the call in normal mode (ear speaker), press the **[F]**. The **[F]** icon disappears.

On the other hand, if you want to end the call in hands-free mode, simply press the **[F]** key or place the phone on the base.

NOTE: Before holding the phone to your ear, make sure the speaker function is turned off. To adjust the volume of the speaker, refer to the Adjusting the Volume section.

■ Redial on registered, R key

The **[F]** key allows you to access the contracted services of your telephone company or switchboard, such as: "Call Forwarding", "Call Waiting", "Answering Machine", etc.

To do this, press the **[F]** key while the handset is off-hook. An **R** will appear on the screen and the line will be timed to open. The control center you are connected to will notice this signal and stand by. Then dial the code for the desired service.

■ ECO mode

The Eco mode of your phone is characterized by the fact that the radiation varies depending on the distance of the phone from the base station. Thus, by controlling the transmission power, you can extend the life and duration of the battery.

28

■ Out of range

The **[F]** icon appears flashing on the screen when the phone loses connection to the base station. When the connection to the base station is restored, the **[F]** icon stops flashing.

When the phone is out of range of the base, the phone will repeatedly sound a warning tone. Bring the phone within range of the base. If you do not bring the phone closer to the base, the call will be dropped.

■ Keyboard lock

To lock the keyboard, simply press and hold the **[F]** key for about 2 seconds in standby mode until the **[F]** icon appears. You will hear a confirmation tone.

If you want to deactivate it now, press the **[F]** button again for about 2 seconds. The **[F]** icon will disappear from the screen and you will hear the confirmation tone again.

NOTE: If the key lock is activated and you receive a call, you can answer the call by pressing the **[F]** button. At the end of the call, the function is automatically reactivated.

■ Do not disturb

This function is very useful when you want to mute the ringtone of your phone so as not to be disturbed.

To activate the "Do not disturb" function in standby mode, simply press the **[F]** key for about 2 seconds until the **[F]** symbol appears. You will hear a confirmation tone.

If you want to deactivate it now, press the **[F]** key again for about 2 seconds. The **[F]** icon will disappear from the screen and you will hear the confirmation tone again.

NOTE: In any case, the indicator light **(11)** on the phone will start flashing when you receive a call. In addition, the text "CALL" is displayed on the screen.

29

■ Phone search

You can search for the phone from the base by ringing it with a special buzzer. This function is very useful to locate a lost phone or to call the person who has it.

To send the search signal, briefly press the **[F]** key (C), located on the base. The phone registered to the base will ring for about 60 seconds. In addition, 'SEARCH' is displayed on the screen.

To stop the search signal before the 60 seconds have elapsed, press the search key again or the **[F]** key on the phone.

ADDRESS BOOK

This device has 20 address book positions for storing phone numbers and their associated names. Each position can store names up to 8 characters and 20 digits for the number. The address book entries are stored in alphabetical order of the names.

ACCESS THE ADDRESS BOOK AND SEARCH FOR AN ENTRY

To check the entries, you can access the address book from the menu:

- In standby mode, press the **⇨OK** key to enter the main menu. The first option that appears is ADDRESS BOOK.
- Press **⇨OK**. The screen displays the first entries in the address book.
- Use the **[13]** and **[14]** keys to scroll through the list. Since the entries are sorted in alphabetical order, you can also use the alphanumeric keypad to perform a quick search for the first letter of the name. And if there are no entries that can be displayed, the phone will indicate on the screen that the address book is empty.

30

CHECK AN ENTRY

Once you have searched the address book for the entry you want to check:

- Press the **⇨OK** key to display the address book options on the screen.
- Press the **[F]** key until the VIEW option is selected. Press **⇨OK**.
- Press the **[F]** key to check the name, number and melody of the selected entry.

NOTE: If the number has more than 8 digits, press the **[F]** key to display the digits of the number on the left side; and press the **[F]** key to display the digits on the right side.

ADD A NEW ENTRY

Once you have accessed the address book entries:

- Press **⇨OK** to access the functions of the address book itself. ADD is displayed.
- Press **⇨OK**. NAME is displayed on the screen.
- Press **⇨OK**. Enter the name (max. 8 characters) using the keypad.

31

• How do I enter characters using the phone keypad?

- You can enter characters by pressing the number keys. For example, to type 'C' you need to press the digit '2' three times, for 'S' you need to press the digit '7' four times.
- If you want to enter characters that are on the same key, you must wait until the cursor moves to the next position before entering the new character.
- If you enter an incorrect character, press **C ⊗** to delete the last character entered. Repeat the process as many times as necessary until the desired character is deleted and continue inserting characters.

Key	How often must be pressed			
	x1	x2	x3	x4
1	Space	--	1	x4
2	*		7	/ \
0				
#	o	'	,	--

- Press the **⇨OK** to confirm. NUMBER is displayed.
- Press the **⇨OK** and enter the number (maximum 20 characters) using the keypad.
- Press the **⇨OK** to confirm. MEL x (where x is one of the 10 melodies) appears on the screen. You can then tell who is calling you by the ringing melody.

32

EDIT AN ENTRY

Once you have searched the address book for the entry you want to edit:

- Press **OK** to access the functions of the address book itself. ADD is displayed.
- Press the key **EDIT** key until EDIT is selected. Press **OK**.
- A flashing hyphen appears on the screen at the end of the name. Delete with the **C** key or change with the keypad. Press **OK**, to confirm.
- A flashing hyphen appears on the screen at the end of the number. Delete with the **C** key or change with the keypad. Press **OK** to confirm.
- The screen displays the ringing melody assigned to the number. Press **EDIT** to change it or press **OK** to confirm.

DELETE AN ENTRY

After you have searched the address book for the entry you want to delete:

- Press the key **OK** to access the options of the address book itself.
- Press the key **DELETE** until DELETE is selected. Press **OK** to confirm the selection. The phone deletes the entry and confirms this with a beep.

33

DELETE ALL ENTRIES

Once you have accessed the address book entries:

- Press **OK** to access the options of the address book itself.
- Press **DELETE** until DELETE A is selected. Press **OK**. 'CONFIRM?' appears on the screen.
- Press **OK** to confirm. The text 'EMPTY' is displayed. The phone beeps once to confirm.

ADDRESS BOOK STATUS

You can check how many address book entries are already occupied and how many are free. Once you have accessed the address book entries, you can:

- Press **OK** to access the options of the address book itself.
- Press **STATUS** to select STATUS. Press **OK**.
- The screen displays XX / 20, where XX is the number of occupied entries and 20 is the total capacity of the address book.

34

TURBO MEMORY

The turbo memories are keys 2-9 on the numeric keypad. By assigning the most frequently used numbers to them, you can quickly and easily dial the 8 most frequently used numbers.

Assign a number to a turbo memory

Once you have accessed the address book entries:

- Press **OK** to access the functions of the address book itself.
- Press the key **TURBO** until the TURBO feature is selected. Press **OK** to confirm.
- KEY X (where x = numeric key 2 ~ 9) is displayed. Press **TURBO** until the numeric key is selected. Press **OK** to confirm.

If no number is yet assigned to the number key you have selected, the phone briefly displays the text EMPTY. Then:

- Press **TURBO** until you select the entry in the address book that you want to link to the number key. Press **OK** to confirm. The phone beeps to confirm.

If the number key you have selected is already assigned to a number, the phone will display the entry directly. Then:

- Press **OK** and select the EDIT option by pressing the **EDIT** button.
- Press **OK** and use the number key to select another address book entry.
- Press **OK** to confirm. The phone beeps to confirm.

NOTE: Refer to the turbo mode section to learn how to use the turbo memory.

35

Delete a number of a turbo memory

Once you have accessed the address book entries:

- Press **OK** to access the functions of the address book itself.
- Press **TURBO** until the TURBO feature is selected. Press **OK** to confirm.
- KEY X (where x = numeric key 2 ~ 9) is displayed.
- Press **TURBO** until the numeric key is selected. Press **OK** to confirm.
- Press **OK** and select REMOVE by pressing **REMOVE**.
- Press **OK** to confirm. The phone beeps to confirm.

SELECT AN ADDRESS BOOK ENTRY

After you have searched the address book for the entry you want to select:

- Press **CALL**. The phone will pick up the connection and dial it for you automatically.

36

CALLER ID

Caller ID is a service that lets you know who is calling you or who called you while you were away.

Please note that your phone company must provide a caller identification service so that the phone can show you the number of the caller. Therefore, contact your phone company and ask them to enable the service.

If the caller's number is in the address book, the same name as in the address book is displayed. When you check the call list, the caller's name is displayed instead of the phone number.

If the message "1 CALL" or "X NEW" is displayed in standby mode, it means that you have 1 or more new incoming calls that have not yet been checked.

ACCESS THE LIST OF RECEIVED CALLS

Your phone can store the last 10 received calls. To check them, you can access the list in two different ways: by keyboard shortcut or by menu.

In a direct way

- In standby mode, press the **CALL** key to access the list directly.
- Use the **UP** and **DOWN** keys to scroll through the list.

37

Through the menu

- In standby mode, press the **OK** key to enter the main menu. The first option that appears is ADDRESS BOOK.
- Press **LIST** to select LIST. Press **OK**. The screen displays the first entries in the address book.
- Use the **UP** and **DOWN** keys to scroll through the list.

CHECK THE LIST

Once you have accessed the list of calls:

- Press **CALL** and scroll through the list.
- The **STAR** icon is displayed on the screen if it is a missed call that has not been reviewed yet.
- When the name is displayed and you want to check the associated number, press the **CALL** key.

SAVE TO ADDRESS BOOK

Once you have searched the call log for the entry you want to save in the address book:

- Press **OK** to access the functions. ADD is displayed
- Press **OK** to confirm. If no name is assigned to the number, NAME is displayed on the screen so that you can do so. Otherwise, the name is displayed directly so you can change it. The screen will display a flashing hyphen at the end of the name. Delete with the **C** key or change with the keyboard.

38

- Press **OK** to confirm. A flashing hyphen appears on the screen at the end of the name. Delete with the **C** key or change with the keyboard.

- Press **OK** to confirm. The phone prompts you to enter the melody you want to assign to the number. Select with the **TURBO** key and press **OK** to confirm.

DELETE A CALL FROM THE LIST

After searching the call log for the entry you want to delete:

- Press **OK** to access the options
- Press **DELETE** until DELETE is selected. Press **OK**. The phone emits a confirmation tone.

DELETE ALL ENTRIES

Enter the call list:

- Press **OK** to access the options.
- Press **DELETE** to select DELETE. Press **OK**, the screen shows 'CONFIRM?'
- Press **OK** to confirm. The text 'EMPTY' appears on the screen. The phone emits a confirmation tone.

39

DELETE VOICE MESSAGE ICON

As described in the **VoiceMail** section, the **VOICEMAIL** icon appears on the screen when someone leaves you a message on your voicemail. After you delete all messages from your voicemail, you will receive a signal from your phone company and the **VOICEMAIL** icon will disappear. However, it may happen that in certain circumstances the message does not disappear for some strange reason. In these particular cases, we recommend that you reset the phone as described in the **Default Settings (Reset)** section.

40

LIST OF THE LAST DIALED NUMBERS

The last 5 calls made are stored in the list of last dialed numbers. They can appear with names if they are already stored in the address book

ACCESS THE LIST

To access the entries in the list of last dialed numbers:

- In standby mode, press the **CALL** key to access the list directly.
- Use the **UP** and **DOWN** keys to scroll through the list.

CHECK LIST

Once you have accessed the list of the last dialed numbers:

- Press **CALL** and scroll through the list.
- When the name is displayed and you want to check the associated number, press the **CALL** key.

41

MULTI-PHONE FUNCTION

You can use the DECT system with multiple phones to:

- Register up to 5 phones on the same base station.
- Register up to 4 bases on the same phone.
- You can make internal calls and transfer calls from one phone to another connected to the same base station.

When you add additional phones to the system, you can:

- Make an internal call from one phone to another,
- Make an internal call during an external call,
- Transfer an external call from one phone to another,
- Set up a three-way conference: 2 internal and 1 external.

When one telephone is on an external call, the other telephones cannot take over the line. If you still want to do this, you will hear warning tones in the handset informing you that the line is busy and an error message will appear on the screen (if your additional telephone is also the Comfort Kaiser or its DUO version).

NOTE: Each phone has its own identifier, which is the number next to the name of the phone. When SPC 1 is displayed, the phone's number is 1. If a phone is not registered to a base station, the text 'NO BASE' will appear on the screen and the **Y** icon will flash. When an additional phone is added to the system, the batteries must be charged as if it were a new phone.

42

REGISTERING A PHONE

By default, the base and the phone are registered at the factory. If for some reason this is not the case, or if you want to register another phone, you need to perform the following steps:

- En la base mantenga pulsada la tecla **CALL** (**C**) durante unos 8 segundos.
- En el portátil, pulse la tecla **OK** para entrar al menú.
- Pulse la tecla **CALL** hasta seleccionar DAR ALTA. Pulse la tecla **OK** para confirmar.
- La pantalla mostrará BASE n (donde n, de 1 a 4). Un * le indicará además la base actual. Pulse la tecla **CALL** hasta seleccionar el número de base deseado. Pulse la tecla **OK** para confirmar.
- El teléfono le solicitará el número de PIN. Introdúzcalo (por defecto 0000). Pulse la tecla **OK** para confirmar. Cuando el portátil se registre en la base, el icono **Y** dejará de parpadear.

NOTE: The number of your telephone is assigned by the base to which you log on. If the base station has already assigned number 1, it will assign phone number 2. If the first attempt to register the phone to the Base Station fails, try again by repeating the process. It is possible to connect a phone of another model to the Base Station, but it is NOT GUARANTEED THAT THIS PHONE WILL FUNCTION WITH THE BASE STATION.

43

SELECT BASE

If you have a phone connected to multiple bases, you can change the base. To do this:

- Press the **OK** key on the phone to enter the menu.
- Press **TELEPHONE** until TELEPHONE is selected. Press **OK** to confirm.
- Press **SEL BASE** until SEL BASE is selected. Press **OK** to confirm.
- BASE n is displayed on the screen (where n ranges from 1 to 4). If the phone is connected to more than one base, press the **CALL** key until the desired option is selected. The currently selected base is marked with an *. Press **OK** to confirm.
- The screen will display 'SEARCH' until the connection to the base is established. When you are done, the phone will display OK on the screen for confirmation.

44

LOG OUT A PHONE

A telephone cannot log itself out. Therefore, proceed as follows from a phone other than the one you want to log out:

- Press the **OK** button on the phone to enter the menu.
- Press **BASE** until BASE is selected. Press **OK** to confirm.
- Press **LOG OUT** until LOG OUT is selected. Press **OK** to confirm.
- PIN? appears on the screen. Use the numeric keypad to enter (default 0000). Press **OK**.
- La pantalla mostrará PT n (donde n es el número de portátil que desea dar de baja). Elija el portátil con la tecla **CALL**. Pulse **OK**.

45

INTERNAL CALLS

You can use the phones free of charge to make calls to each other. You can make an internal call to one or all phones.

Internal call to a telephone

- Press the **C** key on the handset 1. The screen will display the phones registered in the base station. If there are more than two phones, e.g. 1, 2 and 3, press the number you want to call internally, e.g. 2. But if there are only two phones, e.g. 1 and 2, the second one will ring directly.
- Phone 2 starts ringing, the **CALL** icon lights up and the message DE PT 1 appears on your screen.
- To answer the call, press the **CALL** key on the phone 2 and start the call.
- To end the call, any participant can press the **CALL** button.

Internal call to all phones

- Press the **C** key on telephone 1. The screen displays the phones registered in the base station: e.g. 2 and 3. In addition, 9 appears as a code to call all phones simultaneously.
- When you press the number 9, all phones connected to the same base will ring. The **CALL** icon will light up and the message "DE PT 1" will appear on your screens. Meanwhile, "TO ALL" is displayed on the screen of telephone 1.
- Each of them can then respond by pressing the **CALL** button.
- To end the call, any participant can press the **CALL** key.

46

FORWARDING A CALL

You can transfer an external call from one phone to another. To do this, you must perform the following steps during the external call itself:

- On Phone 1, press the **OK** key to enter the menu. INTERNAL appears on the screen.
- Press **OK** to confirm. If there are more than two phones, the screen will show the numbers of the phones connected to the base and the digit 9 as a special code to make a general call to all phones.
- Press one of the keys via the numeric keypad. The symbol **CALL** and 'A PT 2', appear on the screen indicating that you are calling e.g. telephone 2. In the meantime, the external caller will hear music on hold.
- Phone 2 starts ringing and the **CALL** icon and the message "DE PT 1" appear on the screen. To answer the internal call, the other phone must press the **CALL** key.
- To forward the external call to phone 2, phone 1 must press the **CALL** key.

NOTE: If Phone 2 does not answer the internal call after about 30 seconds, the external call is automatically returned to Phone 1. Phone 1 can also cancel the internal call by pressing the **CALL** key.

47

THREE-WAY CONFERENCE: 2 INTERNAL and 1 EXTERNAL

If more than one phone is registered to the base station, you can use this function to make a call between the external call and two phones.

To do this during an external call:

- Press the **OK** key on the phone to enter the menu. INTERNAL appears on the screen.
- Press **OK** to confirm. If there are more than two phones, the screen will show the numbers of the phones connected to the base and the digit 9 as a special code to make a general call to all phones.
- Press one of the keys via the numeric keypad. The **CALL** symbol and 'A PT 2' appear on the screen, indicating that you are calling e.g. telephone 2. In the meantime, the external caller will hear music on hold.
- Phone 2 starts ringing and the **CALL** icon and the message "DE PT 1" appear on the screen. To answer the internal call, the other phone must press the **CALL** key.
- On the phone that initiated the call, press the **CALL** key for a few seconds. The three-way conference call will then be held. CONFER appears on the screen.
- To end the call, either party can press the **CALL** key.

48

TECHNICAL DATA

Identification: DECT.

Radio: Frequency: 1.88 to 1.9 GHz

Power supply:

- Base unit: 6 V DC / 300mA
- Phone device: Ni-Mh batteries: 1.2 V DC, 500mAh (2 x 1.2 AAA).

Network adapter:

External AC/DC transformer for the base unit.

- Input: 100 ~ 240 V AC, 50/60Hz, 150mA
- Output: 6V DC / 300mA

Operating time:

- In idle state: 250 hours.
- Calling: 15 hours.

49

TROUBLESHOOTING

• **The phone does not work or does not behave correctly.**

- Disconnect the charging station from the mains.
- Remove the battery from your phone.
- Reconnect the charging station to the mains.
- Insert the batteries into the phone (pay attention to the position).
- Place the phone in the charging cradle.

• **The phone does not work.**

- Check if the adapter is connected correctly.
- Check that the power cord is properly connected.
- Check that the battery is connected and charged.

• **The phone does not work.**

- Disconnect and reconnect the battery.
- Leave the phone in the cradle and check if the battery indicator on the screen moves.
- Have you charged the batteries for about 10 hours? Check the battery status by looking at the battery level on the phone icon.

50

• **Base and phone are not connected.**

- Register the phone in your base again.

• **No dial tone is heard**

- Check that the power cord is properly connected.

• **The phone does not dial**

- Check that the digits are displayed on the screen each time the key is pressed.

• **It does not ring**

- Make sure that the Do Not Disturb function is not enabled. The icon should not appear on the screen.

• **You hear sounds during the call**

- Change position; move closer to the base.

- Do not place the base station near other electrical devices (TV, computer...) to avoid radio interference.

• **Connected to an ADSL broadband line, no caller ID or poor sound quality.**

- Make sure that you have connected an ADSL filter directly to each outlet used in the house.
- Make sure that the modem and the phone are plugged into the correct filter slot (a separate one for each).
- The filter(s) may be defective. Replace the filter(s) and test again.

51